

BASE MAP REVISED		
5-20-2005	CRAG F. REMINGTON	23924
11-11-2005	CRAG F. REMINGTON	23924
3-9-2006	CRAG F. REMINGTON	23924
12-27-2006	CRAG F. REMINGTON	23924
7-14-2007	CRAG F. REMINGTON	23924
8-27-2008	CRAG F. REMINGTON	23924

DISCLAIMER
 THIS PLAN IS BASED ON THE ORIGINAL PREPARED BY:
 PENNONI ASSOCIATES INC. CONSULTING ENGINEERS & PROFESSIONAL LAND SURVEYORS.
 ENTITLED, "ZONING MAP" SITUATED IN THE TOWNSHIP OF MOORESTOWN,
 BURLINGTON COUNTY, NEW JERSEY, FILE NO. 9090002.
 LAST REVISED: 12-9-2002, LAST PLOTTED: 2-4-2003.

TOWNSHIP OF CINNAMINSON

TOWNSHIP OF DELRAN

TOWNSHIP OF WILLINGBORO

TOWNSHIP OF MAPLE SHADE

TOWNSHIP OF MOUNT LAUREL

OVERALL MUNICIPAL MAP

SCALE: 1" = 800'

WEST MOORESTOWN TOWN CENTER AREA

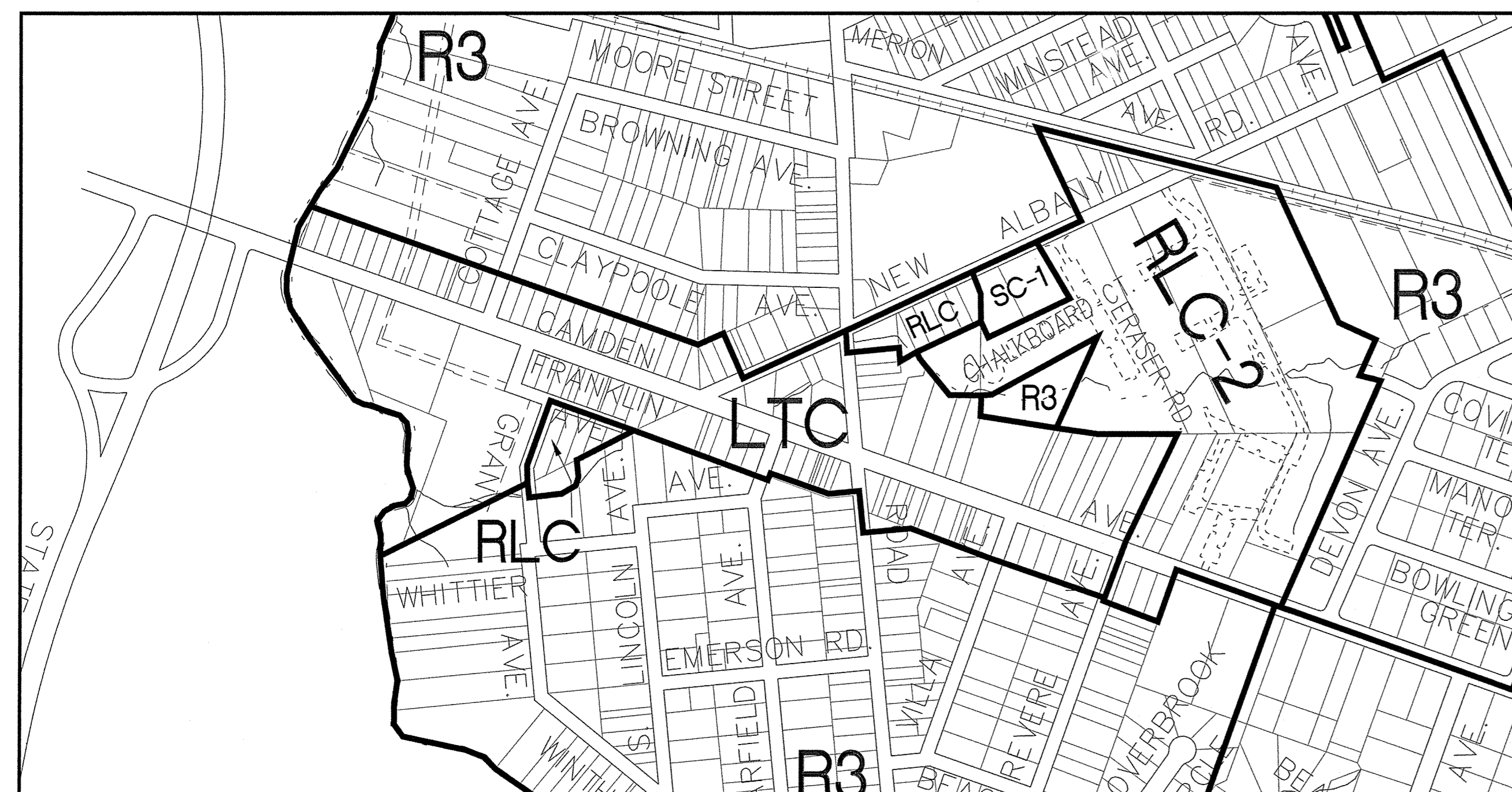

SCALE: 1" = 400'

MAIN STREET TOWN CENTER AREA

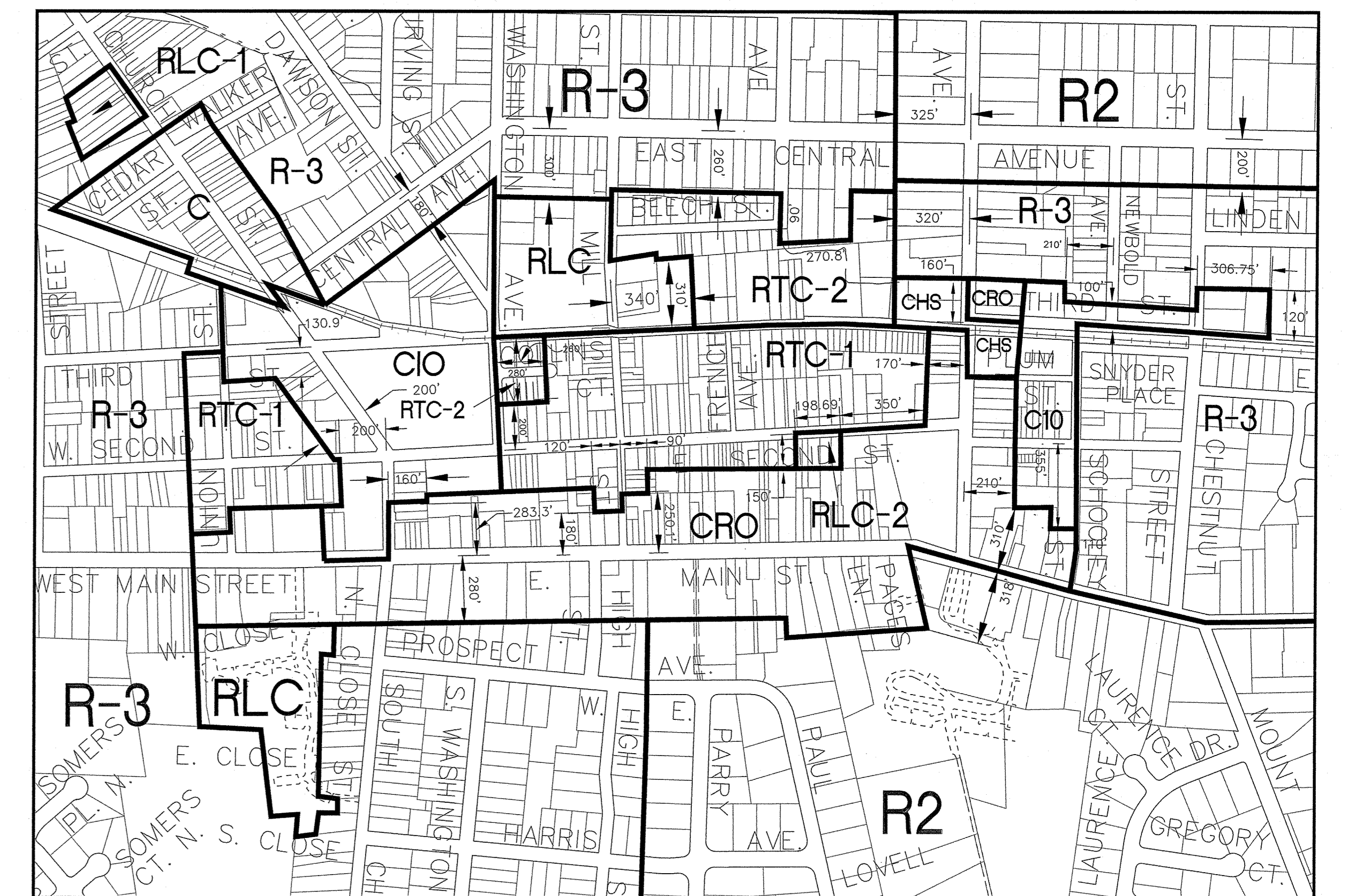

SCALE: 1" = 400'

ZONING DISTRICT DESIGNATIONS

LAST REVISED: MAY 20-2006 (Ord. No. 64-0, 6-7-0, 6-8-0, 10- and 11-2006)
 JANUARY 18-2006 (Ord. No. 39-2005 and 31-2005)
 SEPTEMBER 30-2008 (Ord. No. 20-2008)

- | | |
|---|---|
| R1 - RESIDENCE DISTRICT | C - COMMERCIAL DISTRICT |
| R2 - RESIDENCE DISTRICT | R/PO - RESIDENTIAL/PROFESSIONAL OFFICE DISTRICT |
| R3 - RESIDENCE DISTRICT | SRI - SPECIALLY RESTRICTED INDUSTRIAL DISTRICT |
| RIA - RESIDENCE DISTRICT | SRC - SPECIALLY RESTRICTED COMMERCIAL DISTRICT |
| R-1-Aa - RESIDENCE DISTRICT | SRC-1 |
| R-3-TH - RESIDENCE DISTRICT | SRC-2 |
| L-MR - LOW & MODERATE-INCOME RESIDENCE DISTRICT | RLC - RESIDENCE-LIMITED COMMERCIAL DISTRICT |
| RTC-1 RESIDENCE TOWN CENTER - 1 DISTRICT | RLC-1 |
| RTC-2 RESIDENCE TOWN CENTER - 2 DISTRICT | RLC-2 |
| CIO - COMMERCIAL-INSTITUTIONAL/OFFICE DISTRICT | SC-1 - SENIOR CITIZEN RESIDENCE - 1 DISTRICT |
| CRO - COMMERCIAL-RETAIL/OFFICE DISTRICT | AR-1 - AGE-QUALIFIED RESIDENCE - 1 DISTRICT |
| CHS - COMMERCIAL HIGHWAY SERVICE DISTRICT | LTC - LENOLA TOWN CENTER ZONE |

DATE: 1-6-2006
CRAG F. REMINGTON
 PROFESSIONAL PLANNER LIC. NO. 1877

ZONING MAP
Moorestown Township

BURLINGTON COUNTY NEW JERSEY

SCALE: AS NOTED DATE: 5-20-2005

CRAG F. REMINGTON PROFESSIONAL PLANNER LIC. NO. 1877
JOSEPH M. PETRONGOLO PROFESSIONAL PLANNER LIC. NO. 5251



REMINGTON, VERNICK & ARANGO ENGINEERS
 243 ROUTE 150 - SUITE 200, BORDENTOWN, NJ 08605
 (609) 298-6077, FAX (609) 298-8257
 WEB SITE ADDRESS: WWW.RVE.COM

